

**FEATURES:**

- 1X1 Tab-UP, 1" Long RJ45 with internal magnetics
- 12pin signal pin versions available
- Available with and without LEDs
- Suitable for CAT 5 & 6 Fast Ethernet Cable or better UTP
- Internal magnetics are 100% electrically tested for HI-POT and functionality
- 350  $\mu$ H minimum OCL with 8 mA bias current
- Meets IEEE 802.3 specification

**YUAN DEAN SCIENTIFIC**



**RJ45 Jack**

**56F SERIES**

**With Magnetics**

**10/100/1000 Base-T**

**TAB Up**



**Electrical Specifications@25°C-Operating Temperature 0°C to 70°C**

Part Number	Turns Ratio ( $\pm 5\%$ )	LEDs	Insertion Loss (dB MAX)		Return Loss (dB MIN)		Crosstalk (dB TYP)	Common Mode Rejection (dB TYP)	Hipot (Vrms)
		L/R	0.3-100 MHz	100-125 MHz	0.5-40 MHz	40-100 MHz	1-100 MHz	0.3-100 MHz	@60Hz
56F-1301GYD2NL	1CT:1CT	G/Y	-0.8	-1.2	-18	-12+20log(f/80MHz)	-33+20log(f/100MHz)	-30	1500



Mechanical and Dimension

LED

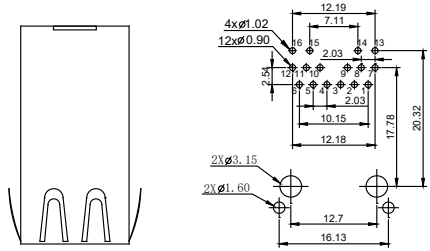

YY:Year WW:Week

PC Board Layout  
Component Side Shown

NO LED

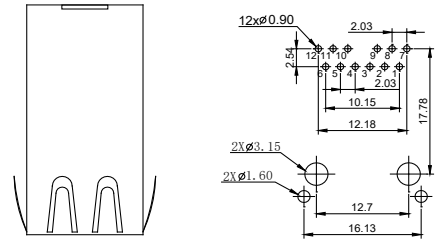

PC Board Layout  
Component Side Shown

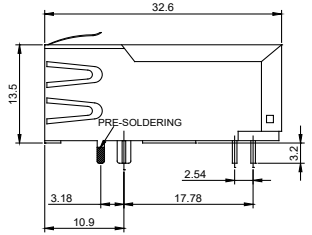
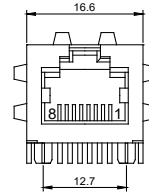
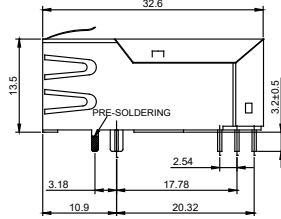
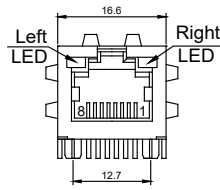

Schematics

56F-1301

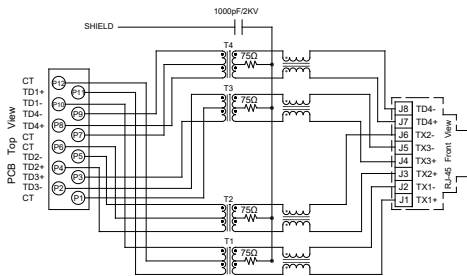

56F-1302

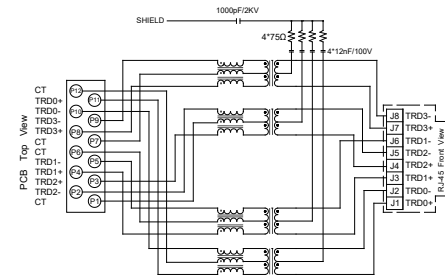

56F-1304

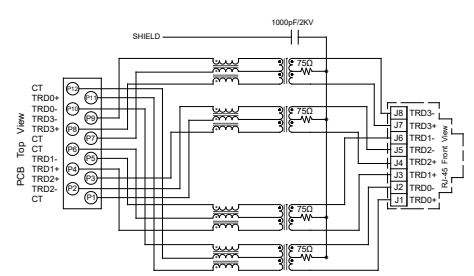

56F-1401

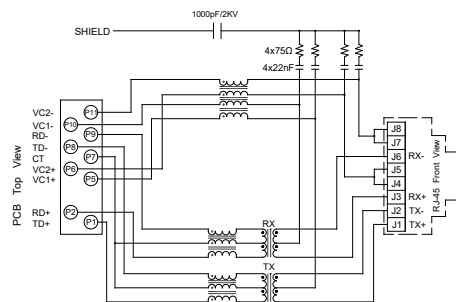

56F-1402

